

COLLECTION
2021

BHIMANI
CERAMIC
CREATING YOUR DREAM SPACE.

THE FUTURE OF FLOORS

EXPLORE
BEAUTIFUL
DESIGNS

GVT
PGVT
600X
1200MM



HELLO AND WELCOME TO
BHIMANI CERAMICS!

Bhimani Ceramics is one of the prominent manufacturers and exporters of technically advanced ceramic vitrified tiles and parking tiles based in Morbi- the ceramic city of India. Bhimani Ceramics is a world of ceramic tiles with an extensive range of high-end ceramic tiles that will give a look of style and distinctiveness to your home and commercial interiors. Our technically advanced infrastructure facilities make it possible to offer you the Touch that you never forget. We are well-equipped with the latest designs and manufacturing amenities. We have constantly contributed towards creating value for our customers with innovative and sustainable products & solutions since 2001. We are committed to designing spaces that come to life and creating designs that turn your doubts into decisions.

Experience the New
Enormous

The Size, thickness and colours are such that it can be used for both indoor and outdoor areas, embracing all kinds of project requirements and offering a wide range of uses: for floors and walls, surfaces to be walked or driven on, and for particularly sophisticated furnishing and design accessories



RESIDENTIAL



GARDEN & POOL



HOTELS



RESTAURANT



MALLS



PUBLIC SPACES

Your tiles, our style

With a variety of designs in the various sizes made by **Sunflora vitrified** experience crafters, give a unique and memorable experience to your visitors that give them reason to always remember a beautiful surface.

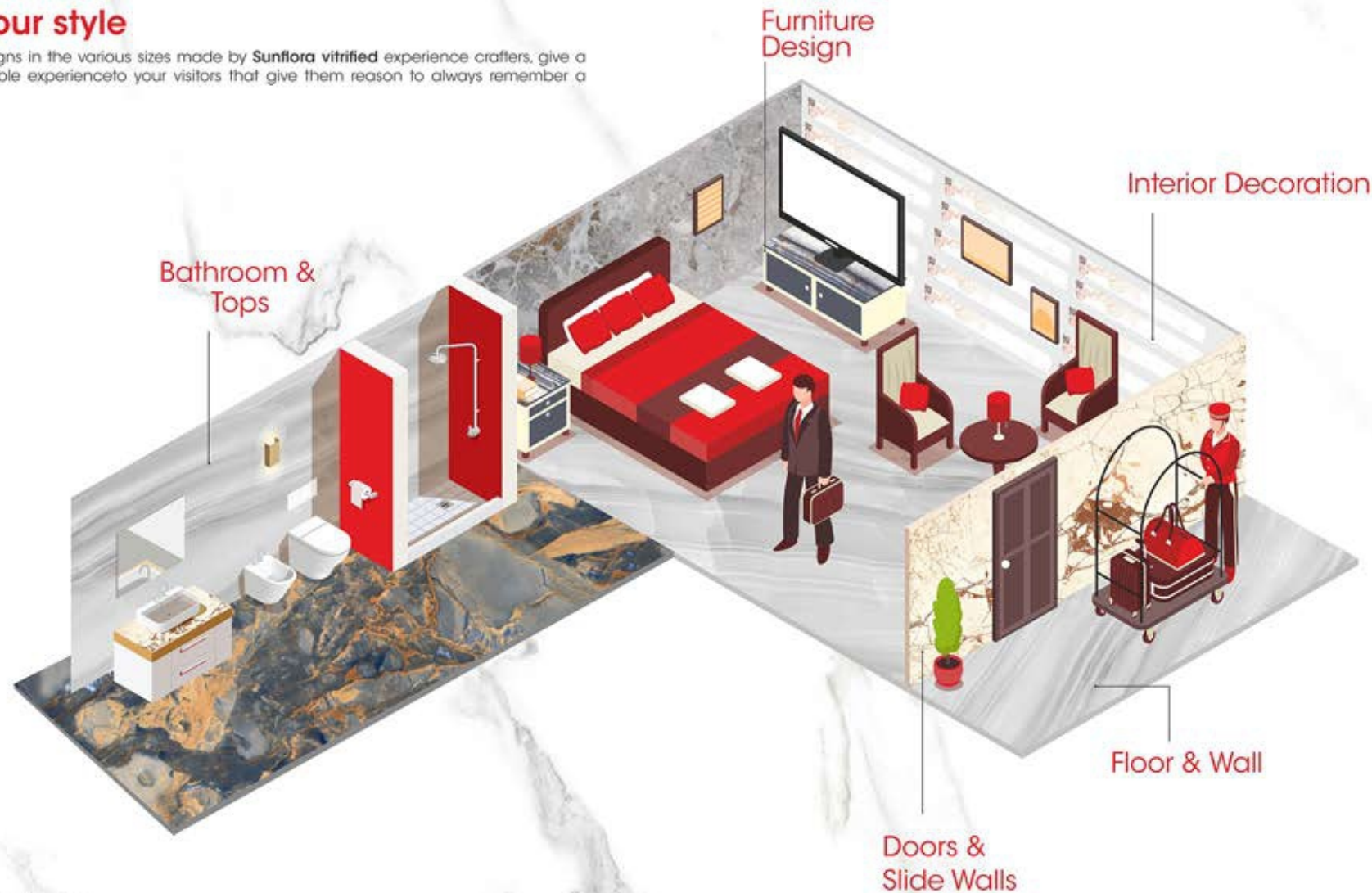

APPLICATIONS



House



Restaurants



Café / Bar



Doors &
Slide Walls



Interior



Floor & Wall



Bathroom &
Tops



Furniture
Design

GLOSSY FINISH

**GVT&
PGVT**
600X1200MM

RANDOM FACE

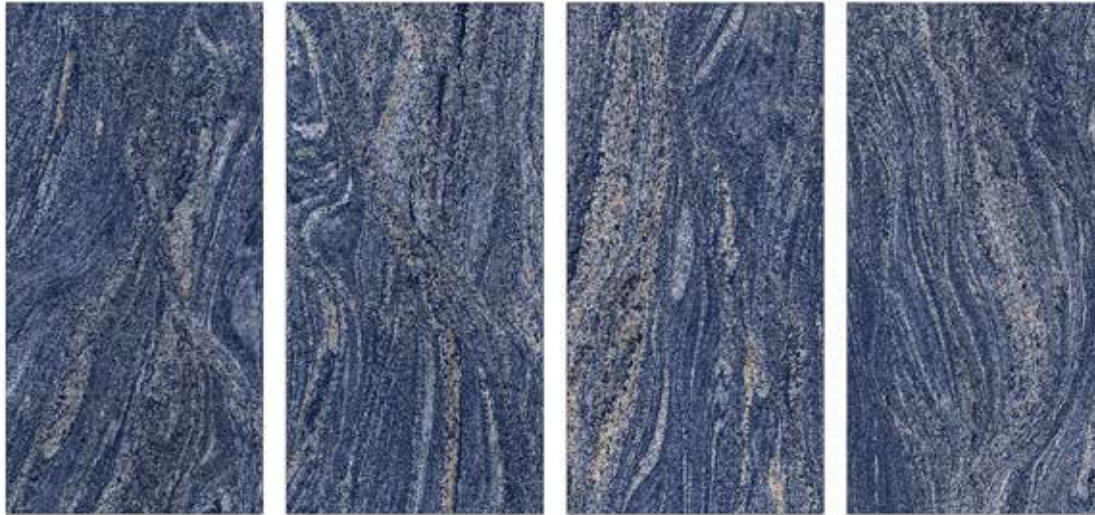

GRANITE AZUL



HIGH
STRENGTH



MULTIPLE
APPLICATION



ECO
FRIENDLY



ZERO
MAINTENANCE

* The visual colour of this product is differ from the actual product colour. Refer the product sample for actual colour.

GLOSSY FINISH

**GVT&
PGVT**
600X1200MM

RANDOM FACE



GRANITE DUST



HIGH
STRENGTH



MULTIPLE
APPLICATION



ECO
FRIENDLY



ZERO
MAINTENANCE

* The visual colour of this product is differ from the actual product colour. Refer the product sample for actual colour.

GLOSSY FINISH

**GVT&
PGVT**
600X1200MM

RANDOM FACE



GRANITE GOLD



HIGH
STRENGTH



MULTIPLE
APPLICATION



ECO
FRIENDLY



ZERO
MAINTENANCE

* The visual colour of this product is differ from the actual product colour. Refer the product sample for actual colour.

GLOSSY FINISH

**GVT&
PGVT**
600X1200MM

RANDOM FACE



GRANITE NEO



HIGH
STRENGTH



MULTIPLE
APPLICATION



ECO
FRIENDLY



ZERO
MAINTENANCE

* The visual colour of this product is differ from the actual product colour. Refer the product sample for actual colour.

GLOSSY FINISH

**GVT&
PGVT**
600X1200MM

RANDOM FACE



GRANITE REDO



HIGH
STRENGTH



MULTIPLE
APPLICATION



ECO
FRIENDLY



ZERO
MAINTENANCE

* The visual colour of this product is differ from the actual product colour. Refer the product sample for actual colour.

GLOSSY FINISH

**GVT&
PGVT**
600X1200MM

RANDOM FACE



GRANITE WHITE



HIGH
STRENGTH



MULTIPLE
APPLICATION



ECO
FRIENDLY



ZERO
MAINTENANCE

* The visual colour of this product is differ from the actual product colour. Refer the product sample for actual colour.

GLOSSY FINISH

**GVT&
PGVT**
600X1200MM

RANDOM FACE



GRANITE WONDER



HIGH
STRENGTH



MULTIPLE
APPLICATION



ECO
FRIENDLY



ZERO
MAINTENANCE

* The visual colour of this product is differ from the actual product colour. Refer the product sample for actual colour.



ADDRESS

8 A, NATIONAL HIGHWAY,
BANDHUNAGAR (MAKANSAR)
MORBI - 363642.

PHONE

DOMESTIC: +91 98252 18131
EXPORT: +91 98000 39000

bhimaniceramics@gmail.com
www.bhimaniceramic.com